

Exhibit Category by Hall

- Hall A [1F]**
Cure & Medical Information Systems
Surgical instruments and products, Rehabilitation equipment
Medical information systems, Robotic surgery system,
Smart Healthcare equipment, Cure equipment,
Pharmaceutical equipment, Cosmetic Dermatology equipment
- Hall B / Grand Ballroom [1F] / Lobby [1F]**
Healthcare & Rehabilitation Equipment Hall
Rehabilitation equipment, Physiotherapy equipment,
Cosmetic Dermatology & Healthcare equipment,
Nursing for Aged items & services, Herbal medical equipment,
Robotic rehabilitation system, Consumable goods
- Hall C [3F]**
Clinical & Diagnosis Equipment Hall
Diagnosis equipment, Laboratory equipment,
Clinical examination equipment, Radiology equipment,
AI Systems, Ophthalmic equipment,
Emergency care equipment, Animal medical devices
- Hall D / Lobby [3F]**
IMAGING, Hospital Facilities, MedcomteK, Medical Korea
Diagnosis & Radiology Imaging equipment, 3D Printer,
Central supply equipment, Dental apparatus, Diagnostic tests,
Disinfectant devices, Hospital facilities,
Emergency care equipment, Medical components,
Quarantine related equipment

Entry Schedule

For overall efficiency of KIMES Exhibitors,
entry schedule for visitors is operated as below;

- ① March 10th & 12th
- Enter by Hall A1 [1st floor]
- ② March 11th & 13th
- Enter by Hall C1 [3rd floor]

※ Allowed daily admittance by entrance/exit of
Hall B, Hall D & Grand Ballroom

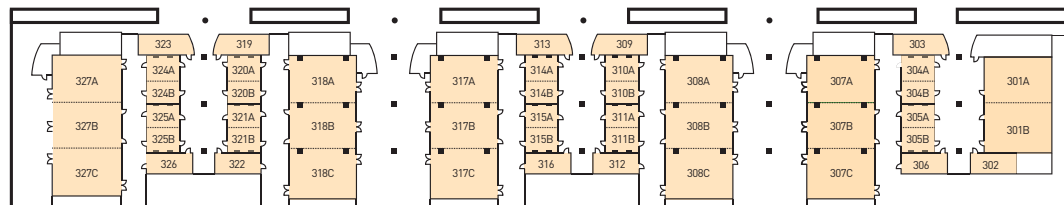
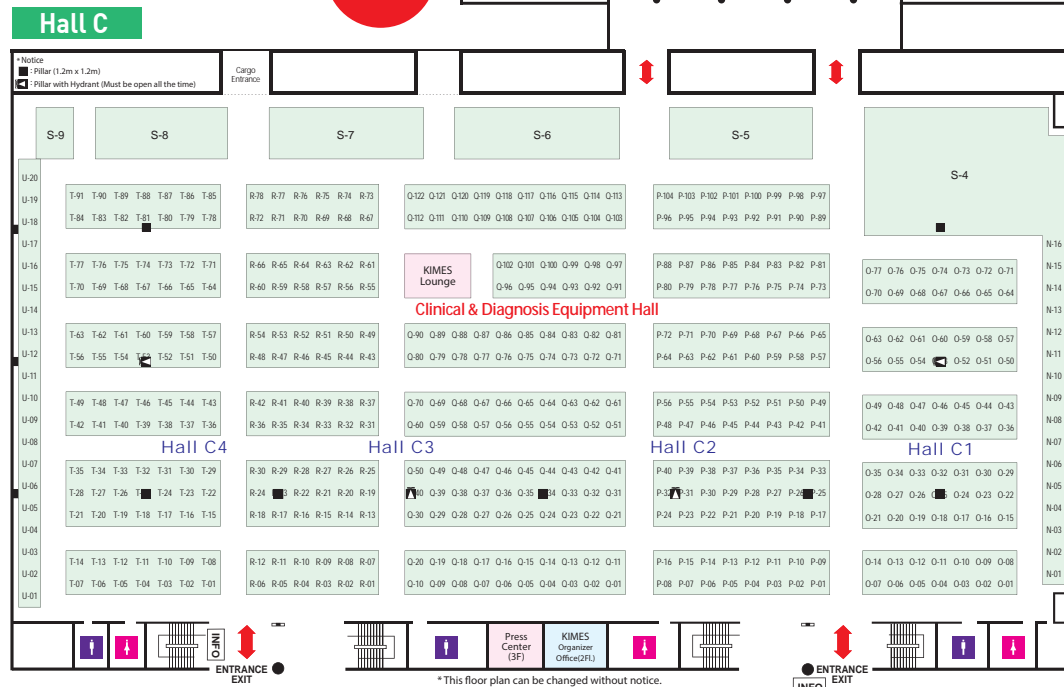

COEX Exhibition Hall

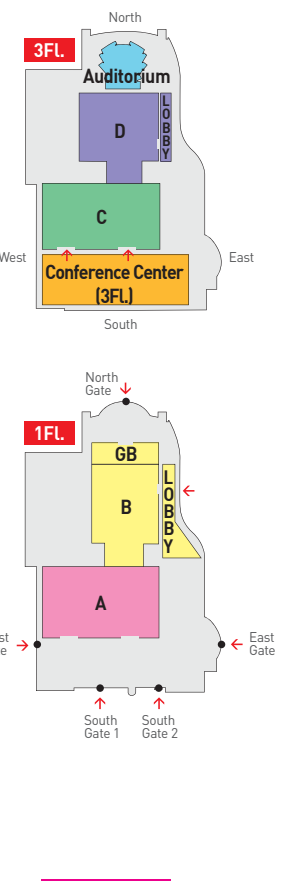

Lobby

Grand Ballroom

Hall B

Hall A

